

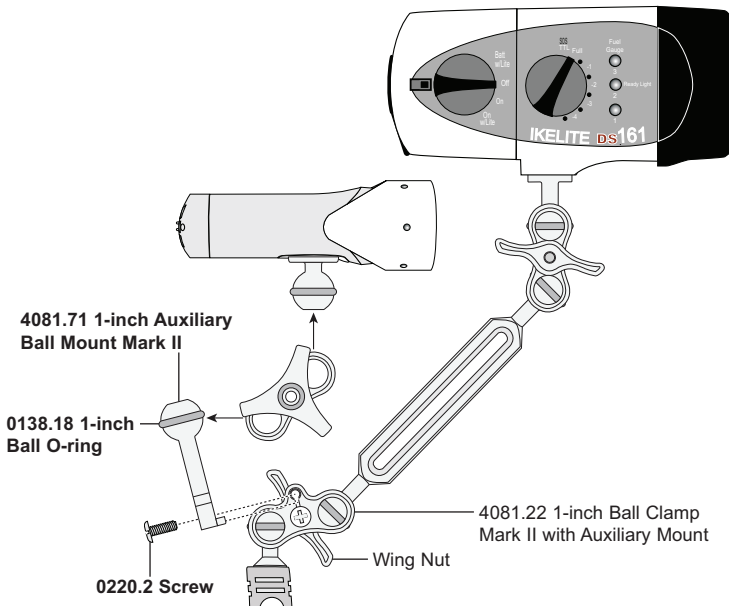

4081.71 1-inch Auxiliary Ball Mount Mark II

Bolded items included in package



Mounts to the Auxiliary Ball Clamp for the attachment of additional lightweight accessories in the middle of your strobe arm. Requires the 4081.22 1-inch Ball Clamp Mark II with Auxiliary Mount, sold separately. Using a flathead screwdriver, tighten the Ball Mount to the Auxiliary Ball Mount Clamp as shown. **Note:** Ball components with an o-ring groove should have an o-ring installed at all times.

Spare Parts

- 0138.18 1-inch Ball O-ring
- 0220.2 1/4-20 X 5/8 Slotted Round Head Screw

Limited Warranty

This Ikelite product is warranted against any manufacturing defects for a period of one (1) year from the original date of purchase. Defective products should be returned to Ikelite postage paid. Ikelite will, at its sole discretion, repair or replace such products, and will return to customer postage paid. All other claims of any nature are not covered. Except as mentioned above, no other warranty expressed or implied applies to this Ikelite product.



**Ikelite Underwater Systems
50 West 33rd Street
Indianapolis, IN 46208 USA**

www.ikelite.com

© 2014 Ikelite Underwater Systems

4081.71_1-inch_Auxiliary_Ball_Mount_MarkII_1-0914