

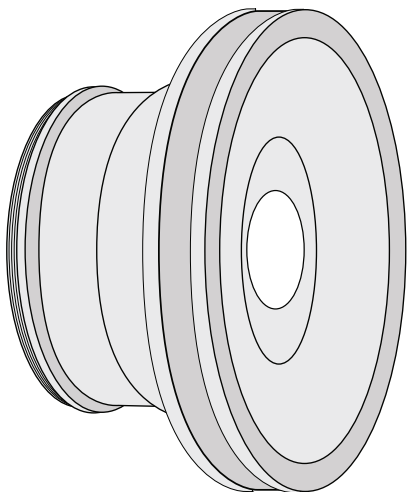

6430 W-30

Wide-angle Conversion Lens Instruction Manual



Thank you for your purchase of Ikelite equipment. Please read this instruction manual completely before attempting to operate or dive with this product. Please refer to the back page of this manual to register your Ikelite product.

Table of Contents

| | |
|--|-----------|
| Specifications | P. 3 |
| Supplied Accessories | P. 3 |
| About the Lens | P. 3 |
| Attaching the Lens to a Housing | P. 4 |
| Taking Photo with the Lens | P. 5 |
| Maintenance and Storage | P. 5 |
| Limited Warranty | P. 6 |
| Returning Products for Service | P. 7 |
| Technical Support | P. 7 |
| Product Registration | Back Page |

Specifications

| | |
|---------------------------|--|
| Magnification |0.59x |
| Diameter |3.8in (96mm) |
| Length |2.1in (53mm) |
| Depth |5.5in (140mm) |
| Weight |1.3 lb (595g) |
| Buoyancy |Approximately 0.76 lb (345g) negative |
| Depth Rating |200ft (60m) |
| Lens Element |4 Group / 4 Elements |
| Lens Material |Optical Glass |
| Body Material |Aluminum Alloy |
| Attachment |67mm threaded |
| Blue Water Filter |6441.42 |
| Green Water Filter |6441.82 |

Supplied Accessories

- Front Cap
- Rear Cap
- Pouch
- Lens Cloth
- Silicone Lubricant

About the Lens

Featuring a new Rare-earth lens element, the W-30 provides improved permeability, clarity and brightness. Specifically designed for digital cameras with 28mm focal length and wider, the W-30 is compatible with Ikelite Video and Digital Still housings using 67mm threaded ports.

Attaching the Lens to a Housing

1. Makes sure the threads of the lens and the housing port are clean of dirt, sand, or other debris.
2. Apply a small amount of silicone grease to the port threads on the housing and to the threads at the rear of the W-20 Lens.
3. Facing the front of the housing, gently screw the lens clockwise and straight into the port of the housing until it securely fastens.
Do not overtighten or use excessive force when connecting the lens to the housing port. If the W-30 lens is overtightened, accidental removal of the housing port can occur when disconnecting the W-30.

This lens can be safely connected and disconnected from the housing while underwater. For correct operation of the optical system, make sure that the space between the housing port and the rear of the W-30 lens is filled with clean water and free of air bubbles.

Ikelite Compact and ULTRAcompact housings with a 2.2" port diameter require a 9306.81 adaptor to attach this lens.

Taking Photos with the Lens

1. After entering the water, check that all of the air has escaped from the gap between the lens and the housing port, and that no air bubbles are present. This step is important and can affect the camera's ability to focus. If air bubbles are present it may be necessary to remove and reinstall the lens underwater.
2. Zoom the camera to its widest-angle setting. If vignetting occurs at this setting (i.e. you can see the edges of the lens in the corners of the picture), zoom the lens in slightly to eliminate.
3. Best photo results will occur under well-lit conditions. The built-in flash of the camera will not supply sufficient light to obtain good results. When using the lens in poorly lit areas, the use of an Ikelite DS Substrobe is strongly recommended.

Maintenance and Storage

After using the W-30 lens in water (especially salt water), rinse with fresh tap water and dry with a soft non-abrasive cloth. The lens surface has an anti-reflective coating. Wipe the surface of the lens gently with the soft non-abrasive cloth to prevent debris buildup that can cause spotting and deterioration of the coating.

Caution: Do not attempt to dry the lens by exposing it to heat from a hair dryer, radiator, etc. This will damage the lens.

Store the lens in a cool, dry place with the front and rear lens caps fitted.

Do not store the lens attached to a housing port. Temperature changes can make the lens hard to remove from the port and cause accidental removal of the port.

Limited Warranty

This Ikelite product is warranted against any manufacturing defects for a period of one (1) year from the original date of purchase. Defective products should be returned to Ikelite postage paid. Ikelite will, at its sole discretion, repair or replace such products, and will return to customer postage paid. All other claims of any nature are not covered. Except as mentioned above, no other warranty expressed or implied applies to this Ikelite product.

Returning Products For Service

Ikelite is most interested in performing any service to ensure that all products perform as intended. Evidence of purchase date must be provided to obtain warranty service.

No prior authorization is required. You may return directly to us or through your dealer. Please include a brief description of the problem, any relevant email correspondence, and/or instructions on what you want us to do. Always include name, shipping address, email address, and phone number inside of the package. Send postage paid to:

*Ikelite Underwater Systems
Attention: Service Department
50 West 33 Street
Indianapolis, IN 46208 USA*

No reimbursements for postage paid will be issued.
You may also want to insure the package.

Returning Products for Service (outside the United States)

For the separate international customs documentation form that you complete to accompany the shipment, please state or designate that the enclosed products were originally manufactured in the USA and are being returned to the manufacturer for repair service. Value of the equipment listed for customs purposes should be zero.

Technical Support

Ikelite Technical Support

Email: ikelite@ikelite.com

Phone 317.923.4523

Fax 317.924.7988

Product Registration

Please go to **www.ikelite.com** to register your Ikelite housing within 15 days of purchase.



**Ikelite Underwater Systems
50 West 33rd Street
Indianapolis, IN 46208 USA**

www.ikelite.com